

61804-2RS1 Deep groove ball bearings

- Popular item

Deep groove ball bearings

Bearing data

[Tolerances](#),

Normal (metric), P6, P5, Normal (inch),

[Radial internal clearance](#),

Matched bearing pairs, Stainless steel
d < 10 mm, Other bearings

Bearing interfaces

[Seat tolerances for standard conditions](#),

[Tolerances and resultant fits](#)

Technical specification

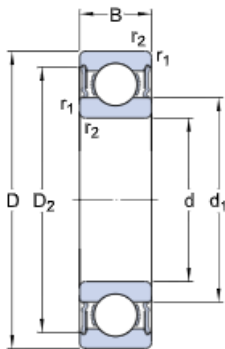

DIMENSIONS

d	20 mm	Bore diameter
D	32 mm	Outside diameter
B	7 mm	Width
d ₁	≈ 23.85 mm	Shoulder diameter
D ₂	≈ 29.4 mm	Recess diameter
r _{1,2}	min. 0.6 mm	Chamfer dimension

ABUTMENT DIMENSIONS

d _c min.	22 mm	Diameter of shaft abutment
d _c max.	23.6 mm	Diameter of shaft abutment
D _i max.	30 mm	Diameter of housing abutment
r _a max.	0.3 mm	Radius of shaft or housing fillet

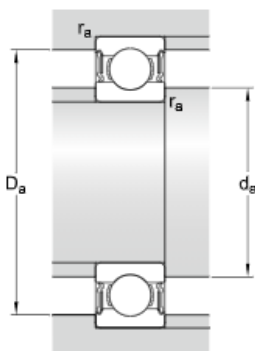

CALCULATION DATA

C	4.03 kN	Basic dynamic load rating
C ₀	2.32 kN	Basic static load rating
P _u	0.104 kN	Fatigue load limit
	13 000 r/min	Limiting speed
k _r	0.015	Minimum load factor
f ₀	14.5	Calculation factor

MASS

	0.018 kg	Mass bearing
--	----------	--------------

TOLERANCE CLASS

Normal	Dimensional tolerances
Normal	Radial run-out